

SHURINK  
—HOME— | **LIFT ② GLOW**

SHURINK  
—HOME— | **LIFT ② GLOW**

## **USER MANUAL**

Classys Inc.

208, Teheran-ro, Gangnam-gu, Seoul, Republic of Korea

Tel : +82-2-1600-8731 | [www.shurinkhome.com](http://www.shurinkhome.com)

Model: CL-ACD3 | Input: DC 5V / 2A

**Facial Massager / Cosmetic Skincare Tool**

For external cosmetic use only. This is not a medical device.

# Table of Contents

## 1. Understanding Your Product

- p. 3 Features
- p. 3 LIFT Cartridge
- p. 3 GLOW Cartridge
- p. 3 Recommended Usage Frequency
- p. 4 What's in the Box
- p. 5 Device Overview & Part Names
- p. 6 Display Information
- p. 7 Care Screen

## 2. Preparing Before Use

- p. 8 Charging the Battery
- p. 8 Checking Charge Status
- p. 8 Voice Guide Settings

## 3. Using the Product [LIFT Cartridge]

- p. 9 Pre-Care Preparation
- p. 10 Cleansing
- p. 10 Applying Gel Cream
- p. 10 Connecting the Cartridge
- p. 11 Performing Care
- p. 11 Powering On
- p. 12 Changing Modes
- p. 12 Adjusting Intensity
- p. 13 Starting/Ending Care
- p. 13 Powering Off

## 4. Using the Product [GLOW Cartridge]

- p. 14 Pre-Care Preparation
- p. 15 Cleansing
- p. 15 Applying Gel Cream (Ampoule)
- p. 15 Connecting the Cartridge
- p. 16 Performing Care
- p. 16 Powering On
- p. 16 Adjusting Intensity
- p. 16 Starting/Ending Care
- p. 16 Powering Off

## 5. LIFT/GLOW Cartridge Usage Guide

- p. 17 LIFT Cartridge Mode-by-Mode Usage Guide
- p. 18 GLOW Cartridge Usage Guide
- p. 18 GLOW Cartridge Usage Guide
- p. 19 LIFT & GLOW Cartridge Synergy Protocol

## 6. After-Care Maintenance

- p. 19 Cleaning Method
- p. 20 Storage
- p. 20 Maintenance & Inspection

## 7. Before Requesting Service

- p. 20 The product does not work properly.
- p. 20 The product does not turn on.
- p. 20 The product generates heat during use.
- p. 20 The charging cradle does not charge.

## 8. Frequently Asked Questions (FAQ)

- p. 21 How much gel cream should I apply?
- p. 21 Can I use this product in the bathroom?
- p. 21 I feel a tingling sensation during use.
- p. 21 Can I use it repeatedly on the same area?
- p. 21 Do I have to use only the dedicated gel cream?
- p. 21 Can I use it after dermatological procedures?
- p. 22 Can I use it after exercise?
- p. 22 Can I use scrubs or peeling products after use?
- p. 22 What if my skin feels dry?
- p. 22 How should I care for my skin after use?

## 9. Product Specifications

- p. 23 Product Specifications
- p. 24 Battery Specifications

## 10. Important Safety Precautions

- p. 24 Warnings
- p. 24 Cautions
- p. 25 Charging Warnings & Cautions
- p. 25 Usage Warnings
- p. 26 Battery Safety Information
- p. 26 Storage Warnings & Cautions
- p. 26 Regulatory Information
- p. 26 FCC Compliance Statement
- p. 26 Product Identity
- p. 26 Manufacturer Information
- p. 27 U.S. Contact / Distributed by
- p. 27 Product Warranty

# 1. Understanding Your Product

## Features

This product is a facial massager designed for home use. Through gentle sonic vibrations and soothing warmth, it helps skin look refreshed and radiant. Various vibration modes and energy care help maintain your skin's condition, providing a professional-level facial care experience at home and helping achieve a smoother, healthier-looking complexion.

It is designed to effectively complement your daily skincare routine.

**This product is a cosmetic skincare tool, not a medical device. It does not provide any medical efficacy or therapeutic effects beyond cosmetic benefits.**

## LIFT Cartridge

Provides focused sonic stimulation to support your skincare routine and help skin look firmer and smoother in appearance. Results may vary.

\* When used with skincare products

## GLOW Cartridge

Provides gentle vibration stimulation to support your skincare routine, helping skin feel more refreshed and look more radiant in appearance. Results may vary.

\* When used with skincare products

## Recommended Usage Frequency

- LIFT Cartridge: 1–2 times per week, depending on skin sensitivity.
- GLOW Cartridge: Daily use (1–2 times per day), depending on skin condition.

	Function	Description
1	<b>Rotary LIFT Cartridge</b>	The treatment head rotates for consistent, even coverage over large areas. Reduces usage time and improves energy distribution precision.
2	<b>Line Mode / Dot Mode</b>	Choose Line Mode (continuous) or Dot Mode (point-by-point) depending on the treatment area and purpose, enabling precise care for both large and small areas.
3	<b>Gentle Sonic Vibration</b>	Delivers deep-reaching vibration stimulation to the skin surface. When used with skincare products, helps skin look brighter and firmer in appearance.
4	<b>Soothing Warmth</b>	Provides gentle, comfortable warmth during use.
5	<b>User Pattern Recognition AI</b>	Built-in AI algorithm analyzes user patterns to maintain optimal energy output, and provides cartridge replacement reminders via voice and rear LCD screen.
6	<b>Overlap Prevention Alert</b>	Prevents repeated energy delivery to the same area, minimizing skin irritation and ensuring safe use.
7	<b>Temperature Sensor</b>	Monitors the medium's temperature in real time during use. Automatically adjusts or shuts off output if overheating is detected.

## What's in the Box

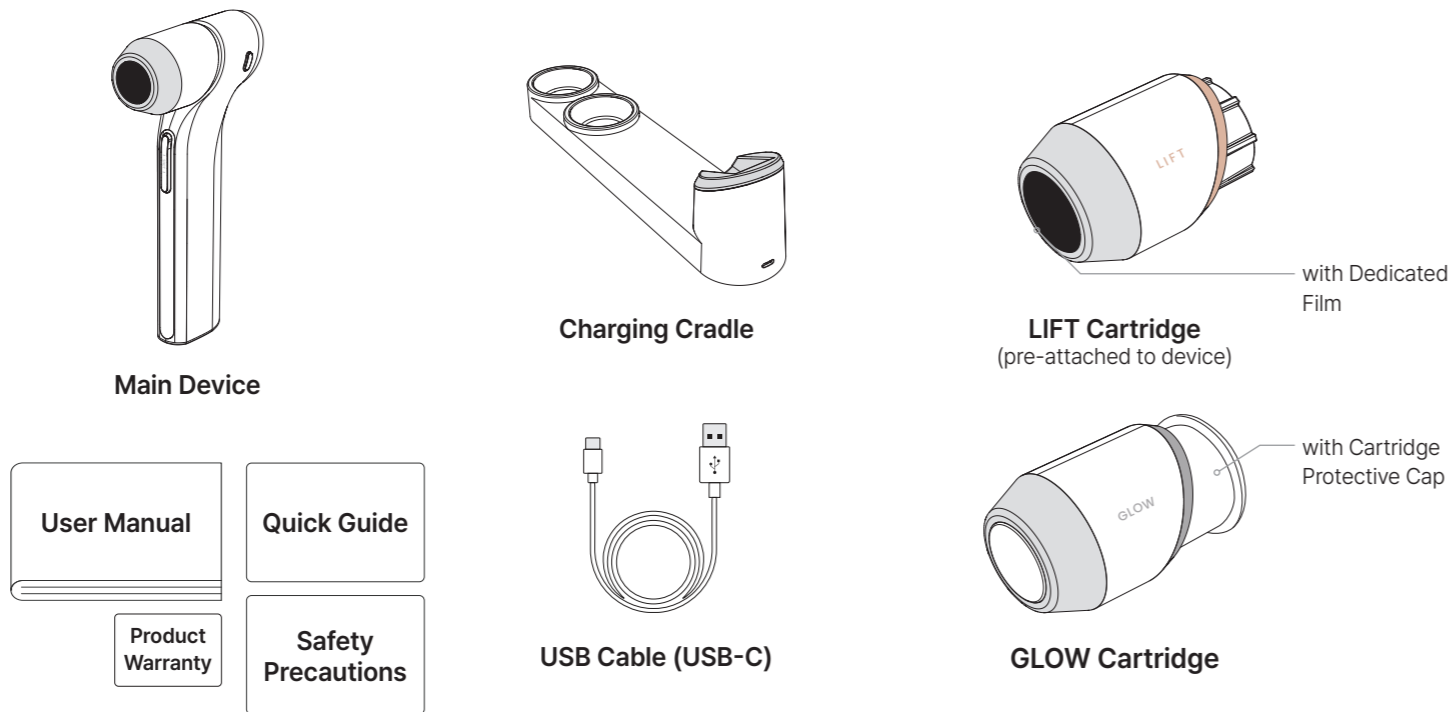

### ⚠ WARNING

Never remove the black dedicated film attached to the LIFT Cartridge's treatment head.

## Device Overview & Part Names

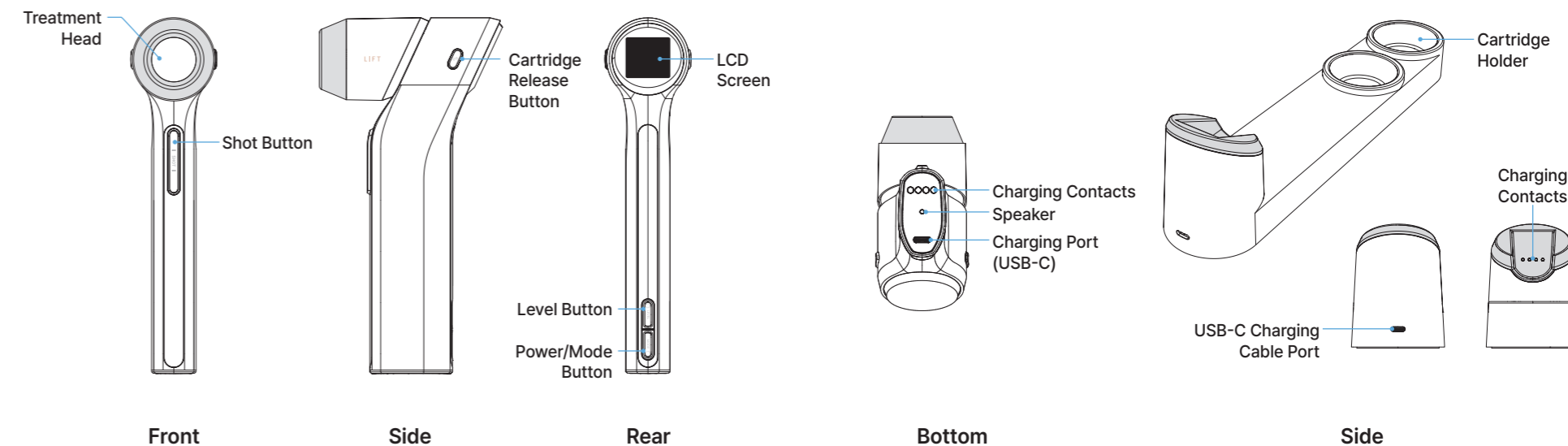

## Display Information

### LIFT Cartridge

#### 1. Energy Status Screen

The LIFT Cartridge recognizes individual usage patterns to maintain optimal energy output at all times. When the cartridge energy weakens due to cartridge consumption, a replacement notification is provided.

\* Average cartridge lifespan: Approx. 2 years

\* After attaching the cartridge and powering on, the brand logo appears followed by the notification screen.



#### Cartridge OK

Displayed when the LIFT Cartridge energy is maintained at normal levels and cartridge condition is good.

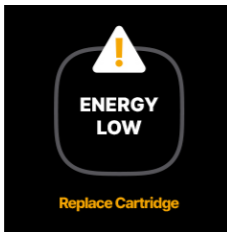

#### Replace Cartridge

Displayed when energy output has weakened due to cartridge consumption. Replace with a new cartridge.

#### 2. Care Screen

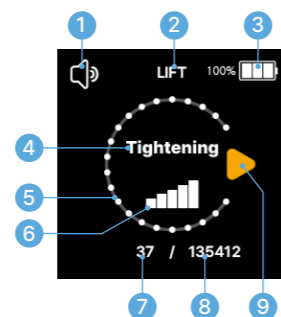

#### ① Voice Guide

Displayed when voice guidance is active

#### ② Cartridge Indicator

LIFT Cartridge

#### ③ Battery Indicator

Shows remaining battery level

#### ④ Care Mode

Face Contour: Skin Firming Care  
V line: Jawline Care  
Eye/Neck: Eye & Neck Firming Care  
Smile Line: Smile Line & Nasolabial Fold Care

#### ⑤ Energy Mode (Dot/Line)

Dot: Precise, focused firming care (shown as dotted line)  
Line: Wide-area skin firming care (shown as solid line)

#### ⑥ Intensity Level

Shows intensity level (1-5)

#### ⑦ Shots Completed

Shows number of shots used in current session

#### ⑧ Cumulative Shots

Shows total cumulative shots used

#### ⑨ Pause/Play

\* Play while Shot Button is pressed; pauses when released

## Care Screen

### GLOW Cartridge

#### 1. Care Screen

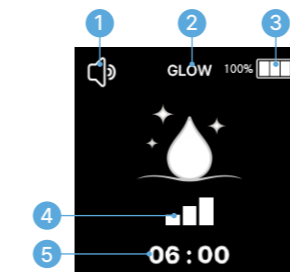

#### ① Voice Guide

Displayed when voice guidance is active

#### ② Cartridge Indicator

GLOW Cartridge

#### ③ Battery Indicator

Shows remaining battery level

#### ④ Intensity Level

Shows intensity level (1-3)

#### ⑤ Care Timer

Shows remaining care time

### Alerts

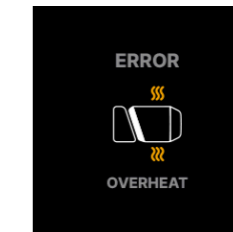

#### Overheat Detected

The overheat prevention sensor shuts down the device when abnormal temperature is detected.

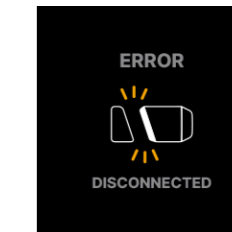

#### Cartridge Connection Error

Displayed when the cartridge is not properly attached. Remove and reattach the cartridge.

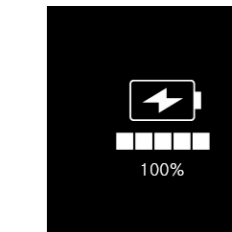

#### Battery Charging Status

Displayed when the device is charging. Battery indicator fills completely when fully charged.

## 2. Preparing Before Use

### Charging the Battery

This product can be charged by placing it in the charging cradle or by connecting the USB cable directly to the device. Before first use, or if the device has not been used for an extended period, fully charge the battery and verify the LCD screen shows a full charge.

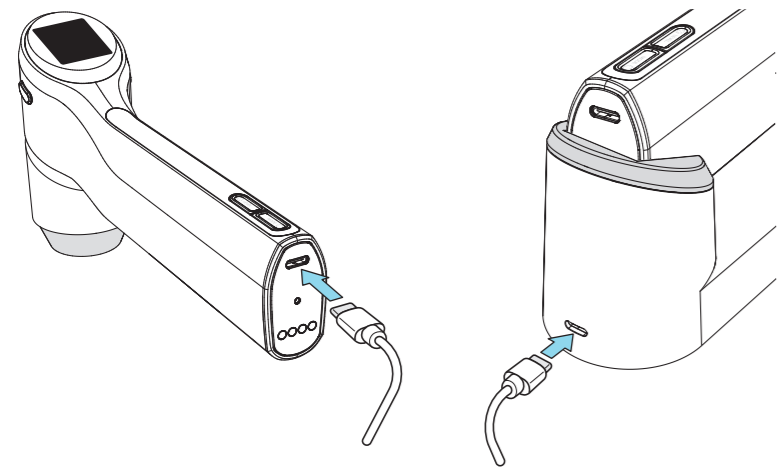

1. Connect the USB cable to a charging adapter.
2. Connect the USB cable to the device's charging port or the charging cradle.
3. Plug the charging adapter into a power outlet to begin charging.

### Checking Charge Status

During charging, the rear LCD screen displays the battery charging status.

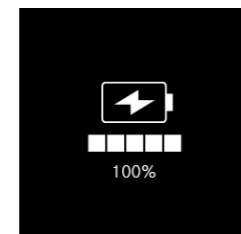

#### Fully Charged

Battery icon shows 100%

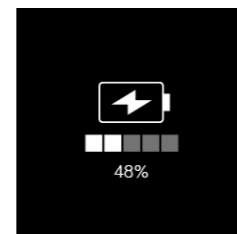

#### Charging

Battery icon shows current percentage with charging animation

### Voice Guide Settings

Press and hold the Level button for 2 seconds to cycle through voice guide options:

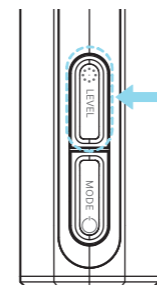
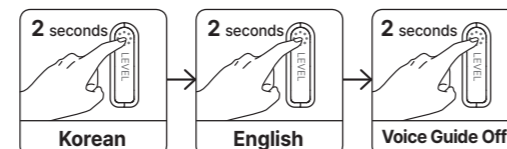

## 3. Using the Product

### LIFT Cartridge



## Pre-Care Preparation

### ⚠ CAUTION

- Areas to avoid :
  - Between the eyebrows (glabella), bridge of the nose, around the eyes, around the mouth (within 1 cm of lip corners), jawbone line, Adam's apple line, and lymph nodes.
  - Thyroid area, areas with recent cosmetic procedures or surgeries.

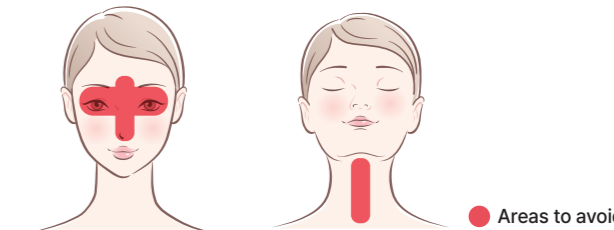

- Adjust the intensity to suit your skin and do not use repeatedly or consecutively on the same line or area.
- Adjust the number of shots according to the size of the area as recommended in the user guide.
- The manufacturer is not responsible for side effects caused by treating areas that should be avoided.
- In Dot Mode, each shot delivers 16 dots sequentially.

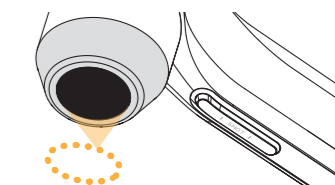

## Cleansing

Remove makeup and gently cleanse your face. Before treatment, remove oil and impurities from the skin to maintain a clean condition.

### ⚠ CAUTION

- Using the device without removing makeup may cause product malfunction due to cosmetic chemical ingredients.
- Products containing the following ingredients may reduce effectiveness: denatured alcohol, UV-blocking agents, retinol, oil-based ingredients.

## Applying Gel Cream

Apply a generous, thick layer of dedicated gel cream to the treatment area.

### 📝 NOTE

If the gel cream dries during treatment, energy delivery may be impaired. Apply a sufficient amount to prevent drying.

## Connecting the Cartridge

1. Prepare the main device and cartridge.
2. Press the cartridge release button and slide in the desired cartridge.

### 📝 NOTE

- Push the cartridge in until you hear a "click" to ensure proper connection.
- To remove: press the cartridge release button while sliding the cartridge forward.



## Performing Care

### ⚠ CAUTION

- Press the treatment head firmly against the skin during use.
- Do not treat the same area that was previously treated.
- Use the product at the correct angle.
- Use Level 1 for thin-skinned areas such as the neck.

- Recommended care angle:  
±50° from perpendicular to skin surface.

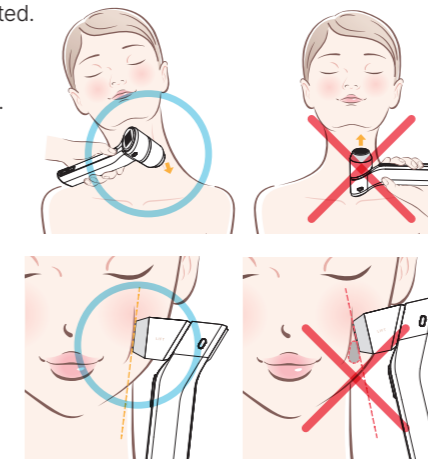
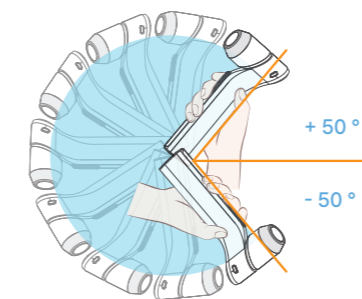

- Repeated use on the same area or incorrect usage may cause skin damage. If skin abnormalities occur, immediately cool the area and consult a healthcare professional.
- Use with the head fully flush against the skin with no gaps.
- Always use with gel cream.

## Powering On

Press and hold the Power/Mode button for 3 seconds to turn on.

\*Brand logo → Mode entry screen appears sequentially.

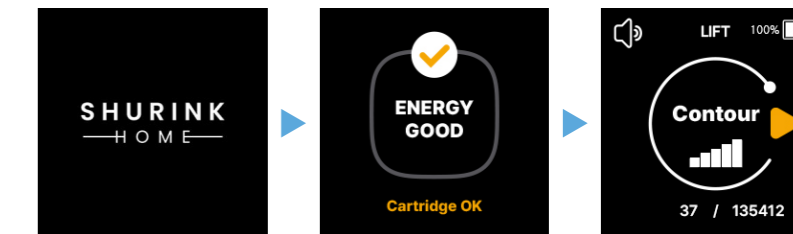

### 📝 NOTE

The device automatically turns off after 1 minute of inactivity.

## Changing Modes

Press the Power/Mode button briefly to switch modes.

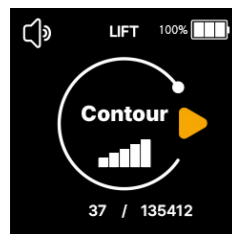

Face Contour Mode | **Skin Firming Care**

Smooths and refines facial skin from the jawline to the cheeks and cheekbones

- Recommended Area : Jaw, cheeks, cheekbones
- Recommended Shots/Time : 150 shots (approx. 8 min)

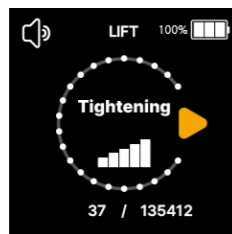

V line Mode | **Jawline Care**

Helps skin around the jawline and chin area look firmer and more lifted in appearance

- Recommended Area : Under chin, jawline
- Recommended Shots/Time : 200 shots (approx. 7 min)

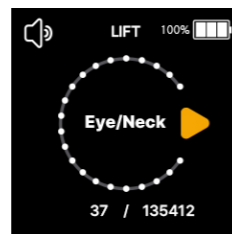

Eye/Neck Mode | **Neck Eye & Neck Firming Care**

Delivers gentle, low-stimulation energy to thin, sensitive areas around the eyes, forehead, and neck

- Recommended Area : Eye area, forehead, neck area
- Recommended Shots/Time :  
Eyes: 120 shots (4 min) Forehead: 120 shots (4 min)  
Neck: 80 shots (3 min)

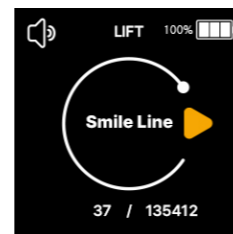

Smile Line Mode | **Smile Line Care**

Gently refines and firms the smile line and nasolabial fold area

- Recommended Area : Mouth area, nasolabial folds
- Recommended Shots/Time : 60 shots (approx. 3 min)

## Adjusting Intensity

Press the Level button to change the output intensity.



### NOTE

Always start at Level 1 when using for the first time, and check your skin's reaction before increasing.

**Eye/Neck Mode and Smile Line Mode: Intensity level cannot be adjusted.**

## Starting/Ending Care

1. After selecting a mode, press the Shot button to begin.
2. Energy is delivered only while the Shot button is pressed; releasing the button immediately stops energy delivery.
3. With the cartridge head pressed firmly against the skin, hold the Shot button and gently glide across the area.
4. Follow the voice guidance during care.

### NOTE

If there is a gap between the head and skin, energy may not be delivered properly. Keep the device firmly pressed against the skin.

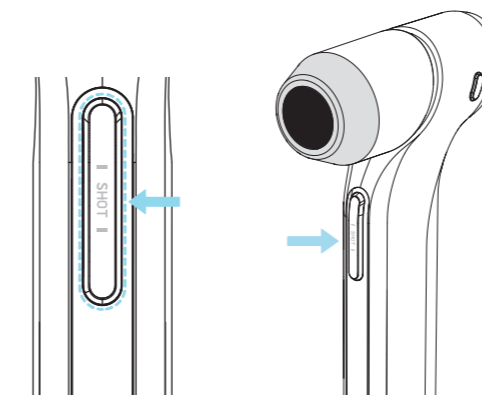

## Powering Off

Press and hold the Power/Mode button for 3 seconds to turn off.

\* Brand logo screen appears.



### NOTE

The device automatically turns off after 1 minute of inactivity.

## 4. Using the Product

### GLOW Cartridge



## Pre-Care Preparation

### ⚠ CAUTION

- Areas to avoid :
  - Between the eyebrows (glabella), around the eyes, around the mouth (within 1 cm of lip corners), jawbone line, Adam's apple line, and lymph nodes.
  - Thyroid area, areas with recent cosmetic procedures or surgeries.



- Apply sufficient gel before use and keep the device pressed firmly against the skin during continuous use.
- If the gel is insufficient or the device is not pressed firmly, sonic vibrations may reflect and generate excessive heat, creating a risk of burns.
- When lifting the device from the skin during use, always press the Shot button to pause first.
- To pause during use, press the Shot button. To resume, press it again.

### Cleansing

Remove makeup and gently cleanse your face. Before treatment, remove oil and impurities from the skin.

### ⚠ CAUTION

- Using the device without removing makeup may cause product malfunction due to cosmetic chemical ingredients.
- Products containing denatured alcohol, UV-blocking agents, retinol, or oil-based ingredients may reduce effectiveness.

### Applying Gel Cream (Ampoule)

Apply a generous, thick layer of dedicated gel cream (ampoule) to the treatment area.

### Connecting the Cartridge

1. Prepare the main device and cartridge.
2. Press the cartridge release button and slide in the GLOW cartridge.

### 📌 NOTE

- Push until you hear a "click." To remove: press the release button while sliding forward.

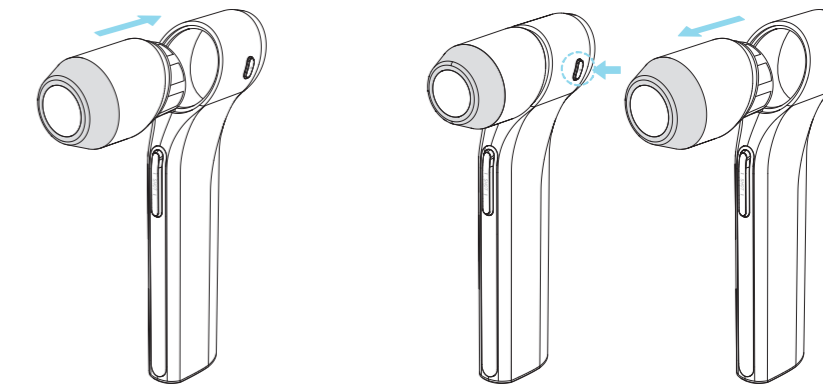

## Performing Care

### Powering On

Press and hold the Power/Mode button for 3 seconds.

\* Brand logo → Mode entry screen appears.



#### NOTE

The device automatically turns off after 1 minute of inactivity.

### Adjusting Intensity

Press the Level button to change output intensity: Level 1 → Level 2 → Level 3 (cycles).

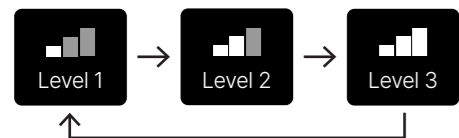

### Starting/Ending Care

1. Press the Shot button once to begin energy delivery.
  - The device operates for 6 minutes automatically.
  - Follow the voice guidance during care.
  - Press the Shot button again to pause; press once more to resume.
3. After 6 minutes, care ends automatically.
  - Completion is indicated by voice and screen display.
  - To extend care, briefly press the SHOT button to restart.

### Powering Off

Press and hold the Power/Mode button for 3 seconds.

#### NOTE

The device automatically turns off after 1 minute of inactivity.

## 5. LIFT/GLOW Cartridge Usage Guide

### LIFT Cartridge Mode-by-Mode Usage Guide

**Face Contour**  
Skin Firming  
Care



Using Face Contour mode, press the device firmly against the skin and gently roll from the jawline, cheeks, and cheekbone area upward from bottom to top for approximately 8 minutes.

**\*Energy is delivered only while the Shot button is held down. Use with the Shot button pressed.**

**V line**  
Jawline Care



Using V line mode, press the device firmly against the skin and slowly glide upward along the jawline and double chin area for approximately 7 minutes.

**\*Each time you hear the 1-shot chime, slowly move the device while holding the Shot button**

**Eye/Neck**  
Eye & Neck  
Firming  
Care

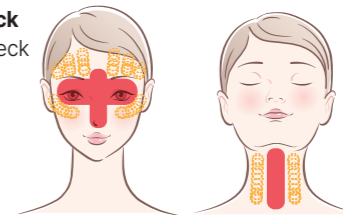

Using Eye/Neck mode, press the device firmly against the skin and slowly glide upward around the eye area and forehead for approximately 4 minutes each, and the neck area for approximately 3 minutes.

**\*WARNING: Do not use on areas marked in red (restricted zones).**

**Smile Line**  
Smile Line Care



Using Smile Line mode, press the device firmly against the skin and gently roll around the mouth area for approximately 3 minutes.

### GLOW Cartridge

Mode	Function	Recommended Area	Recommended Time	How to Use
GLOW	Vibration stimulation that minimizes irritation, helps skincare product absorption, and helps skin feel refreshed and look firmer and more radiant in appearance	Entire face	6 min (Left 3 min, Right 3 min)	Press Shot button once to begin. Use by gently rolling.

### GLOW Cartridge Usage Guide

Areas to avoid, 6 min (Left 3 min, Right 3 min)



#### Jawline & Under Chin

- Move slowly from the center of the chin toward the ears, gliding gently upward from bottom to top.

#### CHEEKS & CHEEKBONES

- Move from the mouth area upward along the cheekbones, gently rolling.

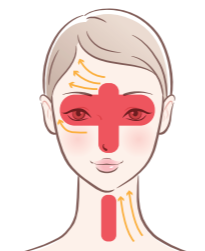

● Areas to avoid

#### Eye Area

- Move gently from inner to outer under-eye area. Avoid use on the eyelids.

#### Forehead

- Glide gently from the center of the forehead outward and upward.

#### Neck

- Glide gently from the center of the neck upward toward the chin. Avoid the Adam's apple and thyroid area.

### LIFT & GLOW Cartridge Synergy Protocol



Sequence	LIFT first, then GLOW	GLOW first, then LIFT
Method	After LIFT care, use GLOW Cartridge to help absorb remaining gel cream on the face.	Apply gel cream or ampoule, use GLOW Cartridge for absorption, then re-apply gel cream generously and use LIFT Cartridge.
Purpose	Firming care followed by skin soothing/radiance care	Skin hydration/vitality care followed by firming care
Best For	Those with sensitive skin concerned about irritation	Those seeking focused firming care with skin that looks vibrant and firm in appearance

## 6. After-Care Maintenance

This product is not waterproof. Do not rinse with water, as this may cause device malfunction. Always clean the device after use to maintain hygiene.

### Cleaning Method

1. Make sure the device is powered off.
2. Wipe the electrode area with a damp cloth.
  - Do not use alkaline cleaners, alcohol, thinner, benzene, acetone, or other solvents.
  - Do not leave gel or residue on the device.
3. Wipe the device with a dry cloth to remove any remaining moisture.

#### ⚠ CAUTION

- Do not scratch or tear the LIFT Cartridge's treatment head film with knives, fingernails, or other sharp objects.
- This product is sensitive to impact. Avoid dropping the device.
- Prevent water or cosmetics from entering the device's ventilation holes or gaps.

## 7. Before Requesting Service

Before contacting customer service, check whether any of the following symptoms apply, and try resolving the issue by following the solutions below. If the problem persists, contact customer service.

### The product does not work properly.

- Verify you pressed the power button correctly.
- Charge the device following the instructions in this manual.
- Check battery status on the rear LCD screen.

### The product does not turn on.

- The product cannot be turned on while charging.
- Connect the charging adapter to a power source.
- Check whether the rear LCD shows battery status during charging.
- Verify the charger is functioning.
- Confirm the device's rated voltage matches your local voltage.

### The product generates heat during use.

- If the device's temperature feels significantly higher than body temperature, stop use immediately and contact the manufacturer.

### The charging cradle does not charge.

- Verify the device and cradle are properly aligned.
- Ensure the charging cable is properly connected to the cradle.

## Storage

- Clean the device before storage if it will not be used for an extended period.
- Turn off the device and disconnect the charging cable when not in use.
- Do not store near heaters, in bathrooms, in direct sunlight, or in unstable locations.
- Store out of reach of children.

## Maintenance & Inspection

- If the device has not been used for an extended period, inspect it carefully and ensure it operates properly and safely before use.
- If the device appears abnormal, refer to Section 7 (Before Requesting Service) to diagnose the issue.
- If the device malfunctions or appears damaged, contact the manufacturer.

## 8. Frequently Asked Questions (FAQ)

### How much gel cream should I apply?

Applying a generous, thick layer of gel to the skin provides a more comfortable experience.

### Can I use this product in the bathroom?

This product is not waterproof. Do not use during face washing, bathing, or with wet hands. Using in a humid environment increases the risk of malfunction. Use in a dry environment.

### I feel a tingling sensation during use.

- Sensitivity may vary depending on individual skin condition. If the sensation feels too strong, lower the intensity using the Level button.
- Tingling may also increase when gel cream dries or is insufficient. Apply gel generously to the treatment head and skin.

### Can I use it repeatedly on the same area?

Overlapping treatment may strain the skin. Gently roll the device to ensure treatment areas do not overlap.

### Do I have to use only the dedicated gel cream?

We recommend the dedicated product for optimal results.

### Can I use it after dermatological procedures?

- Consult a healthcare professional before using after cosmetic surgery or skin treatments.
- Do not use on areas with Botox, fillers, fat grafts, or thread lift procedures.

### Can I use it after exercise?

After intense exercise, blood vessels are dilated and blood circulation is increased, which may make skin more sensitive. After outdoor activity, UV-related skin temperature rise may cause a different intensity of sensation. Use after skin condition has stabilized.

### Can I use scrubs or peeling products after use?

Avoid using scrubs, peeling agents, etc. for at least 2–3 days after product use.

### What if my skin feels dry?

- For LIFT Cartridge: reduce the number of weekly shots.
- Apply moisturizing cream after care.
- If taking medications, consult a professional to determine whether the medication causes skin dryness.

### How should I care for my skin after use?

- Some people may experience redness and warmth. This usually resolves naturally. Avoid saunas and steam rooms for at least one day, and gently cleanse with lukewarm water.
- Apply hydrating sheet masks and moisturizing cream.
- Avoid scrub-type cleansers. Absorb the gel used during treatment fully, and always apply sunscreen before going outdoors.

## 9. Product Specifications

<b>Power</b>	DC5V / 2A (Li-Ion Battery : 3.65V, 3,400mAh)
<b>Size / Weight</b>	Main Device: 198(H) x 48(W) x 102(D) mm With LIFT Cartridge: 275 g / With GLOW Cartridge: 245 g Charging Cradle: 116(H) x 279.3(W) x 56.3(D) mm / 262.5 g
<b>Operating Temperature</b>	5–35°C (41–95°F)
<b>Operating Humidity</b>	0~90 %
<b>Storage Temperature</b>	1–60°C (34–140°F) <b>⚠ Caution</b> Storage below 0 °C may cause cartridge freezing.
<b>Storage Humidity</b>	0~90 %
<b>Recommended Usage</b>	<ul style="list-style-type: none"><li>• LIFT Cartridge: 1–2 times per week (When fully charged, approx. 4 sessions at Level 5, 300 shots per session)</li><li>• GLOW Cartridge: 1–2 times per day (daily use)</li><li>• Battery life may vary depending on battery warranty period, ambient temperature, or usage conditions.</li></ul>

<b>Model</b>	CL-ACD3
<b>Product Name</b>	SHURINKHOME LIFT2GLOW Facial Massager / Cosmetic Skincare Tool
<b>Manufacturer</b>	Classys Inc.
<b>Country of Origin</b>	Republic of Korea (Made in Korea)
<b>Korea RRA Certification No.</b>	R-R-cYs-CL-ACD3
<b>Service Center</b>	+82-2-1600-8731

This device complies with Part 15 of the FCC Rules. Operation is subject to the following two conditions: (1) This device may not cause harmful interference, and (2) this device must accept any interference received, including interference that may cause undesired operation.

## Battery Specifications



KC Safety Certification No.	YU10444-25001
Model	18650
Product Name	Li-Ion Battery
Rating	3.65V, 3,400mAh
Manufacturer	Zhuhai Great Power Energy Co., Ltd
Country of Manufacture	China

## 10. Important Safety Precautions

Changes or modifications not expressly approved by the manufacturer could void the user's authority to operate the equipment.

Safety notices are categorized as "WARNING," "CAUTION," and "NOTE" with the following meanings:

**⚠ WARNING** Improper use of this product may result in minor to moderate physical injury.

**⚠ CAUTION** Improper use of this product may result in property damage.

**📖 NOTE** Provides useful information for product use.

Keep this manual in a readily accessible location after reading.

Read the following information carefully before using this product.

- Do not use this device for any purpose other than those described in this manual.
- This product is not a medical device. Do not use for therapeutic or treatment purposes.
- For external cosmetic use only.

### ⚠ Warnings

- Avoid the thyroid (Adam's apple) area when using on the neck.
- Do not use if you have photosensitivity conditions such as sun allergy.
- Do not use immediately after shaving.
- Do not use while driving, walking, or otherwise in motion.
- This product uses vibration stimulation that may carry a risk of burns. Do not hold the treatment head stationary on one spot. Follow the usage guide in this manual and keep the device moving.
- Remove jewelry from the treatment area before use.

• Consult a healthcare professional before use if any of the following apply:

- \* Skin that is red and tingling from excessive sunburn
- \* Allergic constitution or particularly sensitive skin
- \* Users of implanted electronic devices such as pacemakers
- \* Users of life-support electronic medical equipment such as artificial cardiopulmonary machines
- \* Long-term users of steroid hormone medications
- \* Users with capillary dilation symptoms due to liver dysfunction
- \* Currently receiving outpatient treatment
- \* Areas with inflamed acne
- \* Undergoing dermatological treatment or abnormal skin conditions
- \* Melasma with accompanying itching or melasma caused by physical stimulation
- \* Users of implanted pacemakers, metal prosthetics, or other metallic devices
- \* Hemophilia patients, heart disease patients, acute conditions, bleeding areas, malignant tumors, fracture sites, infectious diseases, eyelid areas, trauma sites, skull areas, children, pregnant women, nursing mothers, and elderly individuals
- \* Those with paralysis or difficulty expressing themselves should not use this product.
- \* Those with eye conditions or who have had eye surgery (LASIK, LASEK)

### ⚠ Cautions

- This is a facial care device; body use is not recommended.
- Use is not recommended for pregnant or nursing women, as hormonal imbalances may temporarily worsen skin conditions.
- Use is not recommended for infants or anyone who cannot clearly express their own will.

**📖 NOTE** Read the following information carefully before using this product.

## Charging Warnings & Cautions

### ⚠ WARNING

- Ensure the charging adapter is firmly plugged in. Use only the specified power and voltage.
- If smoke or unusual odors occur, stop use immediately. Turn off the power and disconnect the charging adapter, then contact the manufacturer.
- Do not damage, modify, bend, twist, or heat the charging adapter or USB cable.
- For user safety, do not use the device while charging.

## Usage Warnings

### ⚠ WARNING

- Do not disassemble, repair, or modify the product.
- This product contains magnetic materials that may adversely affect credit cards, pacemakers, and similar devices. Use with caution.
- Handle the power plug with dry hands only.
- Do not drop or subject to impact.
- When disconnecting cables, pull by the connector end, not the cable itself.
- Handle with care during transport.
- Use caution in dry environments.
- Keep away from open flames.
- Do not use or store near flammable substances.
- Do not use high-voltage electrical products near this device (e.g., electric mosquito rackets).

## Battery Safety Information

This product has a built-in battery system. Fully charge the battery before first use.

- Batteries are consumable; battery usage time will gradually decrease over extended use.
- The built-in battery cannot be removed or replaced by the user. Unauthorized disassembly voids warranty service.
- Contact the manufacturer when battery removal or replacement is needed. Battery service is provided at a fee.

### ⚠ WARNING

- Risk of explosion if the battery is damaged. • Do not heat the battery.
- Do not store or use in temperatures (above 60 °C / 140 °F) or in high-humidity environments (e.g., inside vehicles, saunas).
- If the battery leaks or emits an unusual odor, contact the manufacturer.
- Do not charge using other power devices or circuits.

## Storage Warnings & Cautions

### ⚠ WARNING

- Avoid direct sunlight and locations near heaters or other heat sources.
- Do not store in locations where heat is generated by electrical appliances.
- Do not install in places with excessive humidity, dust, or soot.

### ⚠ CAUTION

- Avoid exposure to direct sunlight in enclosed vehicles.
- Do not use or store in extremely high temperatures (above 35 °C / 95 °F), low temperatures (below 5 °C / 41 °F), or high-humidity environments.

## Regulatory Information

### FCC Compliance Statement

This device complies with Part 15 of the FCC Rules. Operation is subject to the following two conditions: (1) This device may not cause harmful interference, and (2) this device must accept any interference received, including interference that may cause undesired operation.

Changes or modifications not expressly approved by the manufacturer could void the user's authority to operate the equipment.

This equipment has been tested and found to comply with the limits for a Class B digital device, pursuant to Part 15 of the FCC Rules. These limits are designed to provide reasonable protection against harmful interference in a residential installation.

### Product Identity

Product Type: Facial Massager / Cosmetic Skincare Tool

For external cosmetic use only. Not a medical device.

### Manufacturer Information

Manufacturer: Classsys Inc. | Address: 208, Teheran-ro, Gangnam-gu, Seoul, Republic of Korea

Tel: +82-2-1600-8731 | Website: www.shurinkhome.com

Country of Origin: Made in Korea

## U.S. Contact / Distributed by

[U.S. Distributor/Importer Name]

[U.S. Street Address, City, State, ZIP]

[Phone Number] / [Website]

For adverse event reporting or product inquiries in the United States, please contact the U.S. distributor listed above.

## Product Warranty

Product Name	SHURINKHOME LIFT2GLOW (SHURINK HOME LIFT2GLOW)
Model	CL-ACD3

- This product has been manufactured through rigorous internal testing and high-level quality control and inspection processes by Classsys Inc.
- Please register your product serial number on the SHURINKHOME website.
- Free warranty service is available for 1 year from the date of purchase for device defects not caused by customer negligence.

### Service fees apply in the following cases:

- Warranty period has expired.
- Damage caused by customer negligence during the warranty period (e.g., drops, external impacts, water damage).
- Malfunctions resulting from failure to follow the precautions in this manual.
- Unauthorized disassembly or repair by the user.
- Consumable parts have reached end of life.

**Cosmetic defects or damage unrelated to the product's core functions are not covered under free warranty service.**